

Privilege

SIGNATURE **510**



Specification

Superior design refined for a greater sense



Specification

Total Sail area	141 m ²	1,517 sqft
Mainsail	88 m ²	947 sqft
Genoa	53 m ²	570 sqft
Staysail (option)	20 m ²	215 sqft
Gennaker (option)	120 m ²	1,292 sqft
Mast length	21.21 m	69'5"
LOA	17.09 m	56'
Hull length	15.24 m	50'
LWL	15.13 m	49'8"
Beam	7.98 m	26'0"
Draft	1.57 m	5'10"
Displacement light ship	16.8 t	37,000 lbs
Displacement full load	22.8 t	50,700 lbs
Fuel tank	800 l	211 gal
Fresh water	600 l	158 gal
Engine Diesel	2 × 41 kW	2 × 55 HP
Cabins	3 or 4	
CE Certificate	A -12	
Design	Cabinet Marc Lombard	
Interior	Darnet Design	

All measurements are approximate. Specifications and material can change without notice. Errors excepted. Valid 2019.08.01



Specification

General

- › Privilege Signature 510 with master suite layout and 2 guest cabins
- › Declaration of Conformity according to European Directive 2013/53/UE
- › 5 years structural guarantee on hull, deck and bulkheads
- › Owner's manual
- › Administration fees

Hull

General

- › Hulls and bridgedeck infused with closed cells PVC foam core
- › Isophthalic gelcoat – colour: Signal White RAL 9607
- › 1st layer in vinyl ester resin to prevent osmosis
- › Polyester resin for infusion

Structure

- › Monolithic areas and plywood/ aluminium reinforcements under infusion

Bulkheads

- › Structural bulkheads infused with closed cells PVC foam core
- › Bulkheads directly laminated to hull and bridge deck

Additional parts

- › Crash boxes at false bow and transom

Keel

- › Structural keels, integrated to the hulls

Deck

General

- › Deck infused with closed cells PVC foam core
- › Isophthalic gelcoat – colour: Signal White RAL 9607
- › 1st layer in vinyl ester resin

- › Polyester resin for infusion
- › Aft cockpit with L-shape bench on starboard and straight benches on portside and on aft beam

Structure

- › Monolithic areas and plywood/ aluminium reinforcements under infusion
- › Deck laminated to hull and bulkheads laminated to deck

Deckhouse

- › Large coachroof with 3 ventilation hatches and with an extension including LED lights above cockpit
- › Raised helm station on portside with double bench, 1 locker and 1 bag for halyards

Additional parts

- › 2 lockers on foredeck, accessible through deck hatches with ventilation and ladder, lockable
- › 2 lockers on central pod accessible through deck hatches with ventilation and ladder, lockable
- › 1 locker for anchoring storage
- › 1 locker in cockpit for storage of one propane gas bottle 13 kg
- › 6 cockpit lockers with one with double access to life raft
- › 2 cockpit lockers in the aft beam

Rigging

Standing rig

White lacquered aluminium mast 23.90 m high with:

- › 2 sets of spreaders with leather protection
- › Mainsail track with ball bearing sliders
- › Manual winch LEWMAR 50ST EVO at the foot on starboard side for genoa, staysail and gennaker/ spinnaker
- › 4 retractable steps to gooseneck, footrest at gooseneck, 2 retractable steps at masthead
- › LED tricolour navigation light at masthead, steaming light, anchor light, fixed deck light in front of the mast
- › Mechanical wind vane at masthead

Specification

White lacquered aluminium boom with:

- › Sheaves for reef-lines
- › Mainsail outhaul on fixed points

White lacquered aluminium welded crossbeam with seagull striker

Stainless steel 1x19 wire including forestay, inner forestay, 2 lower shrouds, 2 upper shrouds and 4 diamonds

Sails and running rig

High performance running rigging, Dyneema core with:

- › 1 halyard for mainsail, genoa and staysail
- › 2 sheet for mainsail and 2 sheets for genoa
- › 1 genoa furling line
- › Reefing lines, lazy jacks and topping lift

High quality sails with:

- › Roach mainsail 87 m², 3 reefs, full batten, Dacron
- › Genoa on manual furler, 53 m², with UV leech guard, Dacron

Deck hardware

- › 2 electric LEWMAR 55EST EVO halyard winches
- › 1 electric LEWMAR 65EST EVO mainsail winch
- › Mainsheets on tackle and fixed points
- › Manual furler for genoa
- › 2 tracks for genoa/ staysail incl. cars with stop pins
- › 3 winch handles with holders

Exterior equipment

Glazing

- › Stainless steel patio door to saloon with 3 leaves, 2 sliding
- › Large mineral glass windows on hull and deckhouse
- › Flush hatches on deck and deckhouse

Mooring – Anchoring

- › 8 stainless steel mooring cleats, 500 mm 4x, 360mm 4x
- › 8 stainless steel anti-chafing protections
- › 2 stainless steel mooring cleats, 360 mm, at transom
- › 4 mooring lines
- › 8 fenders, 91 cm x 36 cm
- › 1 electric anchor windlass 2000W with deck switch gypsy Ø 12mm
- › Bow anchor roller with cleat
- › Mooring bridle
- › Stainless steel plate to prevent anchor chain chafing
- › Main mooring line with galvanized Delta-Anchor 40 kg, swivel, 75 m galvanized chain Ø 12 mm, 25 m rope

Deck fitting

Deck

- › 2 stainless steel pulpits with teak seats and LED navigation lights
- › 4 stainless steel pushpits, 2 outside, 2 inside transoms
- › Railing, 750 mm height, incl. stanchions and 3 guardlines in stainless steel
- › 2 white PVC coated nets 1000 g/m²
- › 2 handrails on deckhouse
- › 3 lifelines in stainless steel, 2 on the deck, 1 on the deck house
- › Stairs from cockpit to side deck

Aft cockpit

- › Fixed teak cockpit table
- › Stairs from cockpit to helm station

Helm station

- › Double seat
- › Windscreen in plexiglass with stainless steel frame

Transoms

- › Fixed stainless steel swimming ladder on port transom

Specification

Upholstery:

- › Upholstery for cockpit - Silvertex 122-0001 Macadamia

Interior

General

- › Furniture - Alpi Walnut style, satin varnish
- › Floorboard - laminated wood Resopal Valley Oak
- › All worktops in synthetic resin - Solid range S028 Ivory White
- › Upholstery - Silvertex 122-0001 Macadamia
- › Lining ceiling and wall: Spradling Hitch Iceberg 8969 except center saloon ceiling in Spradling Silvertex Ice 4004
- › White solid surfaces: Duropal Cristal White U11026 SM
- › Dark solid surfaces: Egger Graphite Grey U961 STPT
- › Curtains type OCEANAIR in all the boat
- › Spring frames and mattresses for all the beds

Front cabins - According to layout

Master suite

- › 1 dressing
- › 1 large and tall cabinet with 3 doors incl. 1/3 shelves 2/3 wardrobe
- › 1 large desk with storage
- › 1 large and tall cabinet with 3 doors
- › 1 large and tall cabinet with integrated mirror & numerous storage and drawers
- › 1 lengthwise double bed 160 cm x 200 cm, 2 bedsides, 2 low cabinets with drawers
- › 1 separate shower with thermostatic tap and silk-screened door
- › 1 large and tall cabinet incl. 1/2 wardrobe 1/2 shelves, chest of drawers with 2 drawers at the top and shoes storage at the bottom
- › 1 tall wardrobe with drawers at the bottom, 1 separate electric toilet
- › 1 head cabinet with 2 doors and 1 counter top wash basin

- › 1 large and tall cabinet with integrated mirror & numerous storage and drawers

Master cabin + port guest cabin

- › 1 separate shower with thermostatic tap and silk-screened door
- › 1 large and tall cabinet incl. 1/2 wardrobe 1/2 shelves, chest of drawers with 2 drawers at the top and shoes storage at the bottom
- › 1 separate head with electric toilet, wash basin, mixing tap, mirror and accessories
- › 1 lengthwise single bed 105 cm x 200 cm
- › 1 large and tall cabinet with integrated mirror & numerous storage and drawers
- › 1 lengthwise double bed 160 cm x 200 cm, 2 bedsides, 1 low cabinets with drawers
- › 1 separate shower with thermostatic tap and silk-screened door
- › 1 large and tall cabinet incl. 1/2 wardrobe 1/2 shelves, chest of drawers with 2 drawers at the top and shoes storage at the bottom
- › 1 tall wardrobe with drawers at the bottom, 1 separate electric toilet
- › 1 head cabinet with 2 doors and 1 counter top wash basin
- › 1 large and tall cabinet with integrated mirror & numerous storage and drawers

2 double cabins

- › 1 separate shower with thermostatic tap and silk-screened door
- › 1 large and tall cabinet incl. 1/2 wardrobe 1/2 shelves, chest of drawers with 2 drawers at the top and shoes storage at the bottom
- › 1 separate head with electric toilet, wash basin, mixing tap, mirror and accessories
- › 1 transverse double bed 160 cm x 200 cm, 2 bedsides, 1 low cabinet on footboard
- › 1 large and tall cabinet with integrated mirror & numerous storage and drawers
- › 1 separate shower with thermostatic tap and silk-screened door

Specification

- › 1 large and tall cabinet incl. 1/2 wardrobe 1/2 shelves, chest of drawers with 2 drawers at the top and shoes storage at the bottom
- › 1 transverse double bed 160 cm x 200 cm, 2 bed-sides, 1 low cabinet on footboard
- › 1 large and tall cabinet with integrated mirror & numerous storage and drawers

Port corridor

- › 1 tower in front of the stairs with 1 stainless steel freezer 130 l at the bottom & cabinet at the top
- › 5 stairs with courtesy lights & escape hatch

Starboard corridor

- › 1 technical cabinet for washer/ dryer in option
- › 5 stairs with courtesy lights & escape hatch

Aft port side - guest cabin

- › 1 lengthwise double bed 160 cm x 200 cm
- › 1 full length wardrobe on inner side
- › 1 separate head with electric toilet, wash basin, mixing tap, mirror and accessories
- › 1 separate shower with thermostatic tap and silk-screened door

Aft starboard side - guest cabin

- › 1 lengthwise double bed 160 cm x 200 cm
- › 1 full length wardrobe on inner side
- › 1 separate head with electric toilet, wash basin, mixing tap, mirror and accessories
- › 1 separate shower with thermostatic tap and silk-screened door

Galley & salon

Dinning area

- › 1 L-shape bench
- › 1 fixed rectangular dining table
- › 1 cupboard behind the fixed leave of the patio door

Front cabins - According to layout

- › 1 gas cooker 3 burners
- › 1 gas oven
- › 1 built-in dish washer, 9 dishes in option
- › 1 stainless steel fridge 130 l without freezer
- › 1 large sink with mixing tap
- › 1 integrated waste bin
- › Worktop in synthetic resin
- › Numerous storage and drawers

Navigation area

- › Chart table with footstool
- › Wall panel for receiving electronics, monitoring and entertainment
- › Adjustable LED light

Specification

System

Air

Air conditioning

- › A/C system predisposition for future chiller, power and sea water connection, handlers power and chilled water/glycol circuit, insulation hoses

Electrics & electronics

General

- › 12Vdc network
- › 230Vac, 50Hz network
- › Supervision system management with controller for data capture and touch screen 10" to check: AC/DC networks, gauges & pumps, lighting, service switches, alarms

Wiring & control boxes

- › Set of control boxes divided into the boat incl. breakers and control relays
- › Shore power outlet 230Vac, 50Hz, 32A with shore cable

Batteries & chargers

- › 4 service gel batteries 200Ah, 12Vdc
- › 2 gel batteries 55Ah, 12Vdc for engines
- › 1 gel battery 55Ah, 12Vdc for generator
- › Inverter, charger 3kW, 120A, 3000W, 12V

Generator

- › Generator power to be defined according to energy needs and/ or navigation program

Lighting

- › LED downlights daylight divided into the boat incl. cockpit, white and red in saloon and aft cockpit
- › LED reading lights daylight divided into the cabins
- › 1 flexible reading light at chart table
- › 2 LED lights on each transom

Electric devices

- › 230Vac, 50Hz circuit with 1 outlet in each cabin, 2 in the master cabin, 2 in the galley, 1 in the saloon and 2 at chart table = 9
- › Twin USB charging at chart table

Navigation instruments

- › 2 Raymarine i70s at helm station with DST transducers for Depth/Speed/Temperature/Wind
- › GPS Receiver RS150
- › VHF antenna, 2 Ray 90 at helm station & chart table
- › Magnetic compass, northern hemisphere
- › Mechanical wind vane

Entertainment

- › Hertzian masthead antenna
- › AM/FM Antenna
- › Prewiring TV and Hifi in saloon and cabins

Specification

Propulsion

General

- › 2 sound-proof and heat insulated engine compartments, ventilation fans, LED lights with access from cockpit by hatches
- › 2 Yanmar engines, saildrive 57 hp, with electric throttles incl. maintenance kit
- › 2 3-blade Gori folding propellers

Steering

- › Hydraulic steering system
- › Stainless steel steering wheel Ø 900 mm with leather cover
- › 2 stainless steel emergency tillers

Water & gas system

- › 2 stainless steel fresh water tanks, 2 x 300 l
- › 40 l hot water boiler, 230V
- › Pressurized water system with stainless steel expansion tank
- › 2 manual bilge pumps with 3-way-valve
- › 4 electric bilge pumps with visual and audible alarms
- › Electric shower pumps
- › 2 polypropylene blackwater tanks, 2 x 106 l
- › Mixing taps for heads and showers
- › Electric toilets with fresh water flush
- › Warm/ cold water deck shower on port transom

Fuel

- › 2 aluminium fuel tanks 400 l each

Deck & cabin concept

Maindeck

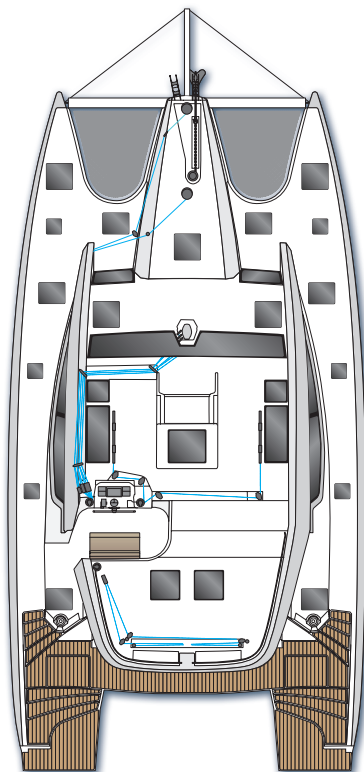

Lower deck

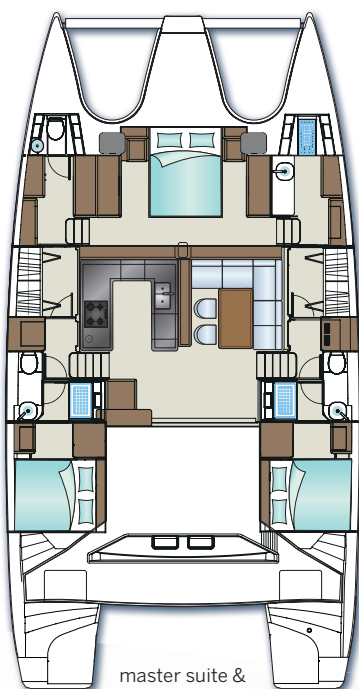

master suite &
2 guest cabins

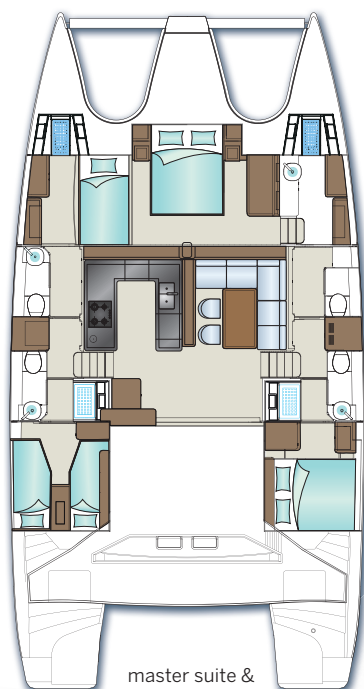

master suite &
3 guest cabins
option

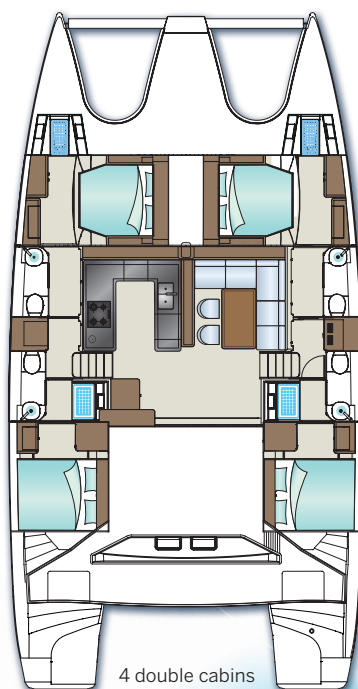

4 double cabins
option